

Getting Started Guide

SEL Online Learning Supports with Rethink ED!

Let's start by exploring how Rethink Ed can help you create and support your digital classroom for the upcoming School Year.

With Rethink Ed Social Emotional Learning (SEL) you will have access to:

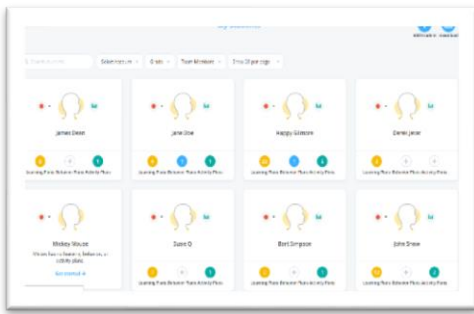

Students

Create your classroom- view, assign and monitor all your students' progress

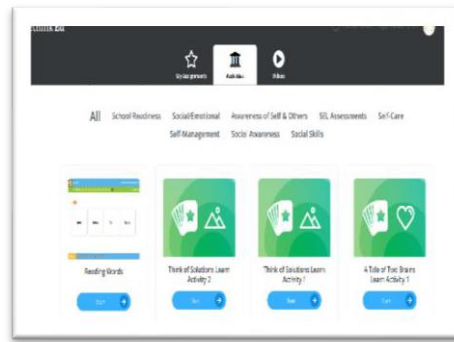

Student Learning Center

Set up SEL/Social Skills daily activities, videos, assignments, and quizzes for your students

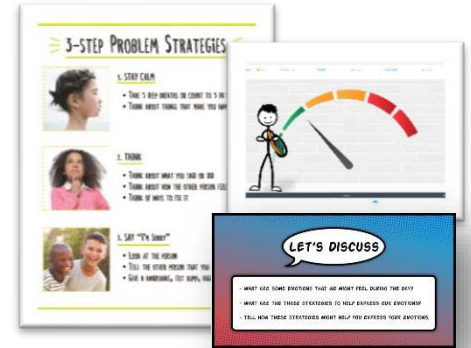

Student Lessons

Access to K-12 curriculum to support **ALL** learners-includes lesson plans, instructional materials, student videos, discussions, visual supports

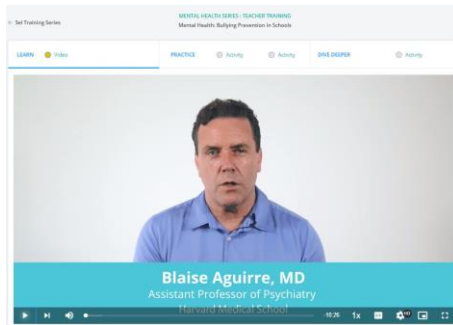

Adult Professional Learning

38 video modules designed for adult learners to support emotional wellness and mental health

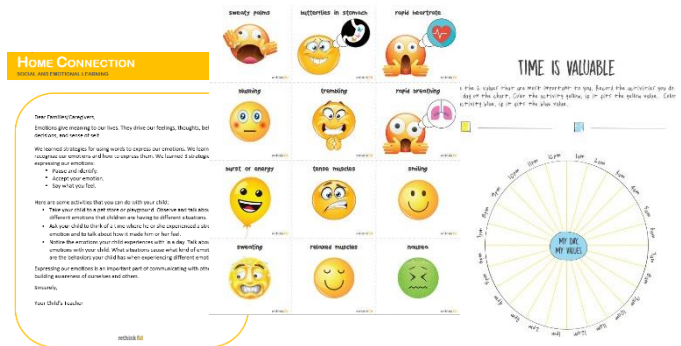

Materials & Resources

Library of materials and resources to include English and Spanish home connections, academic connections, informational sheets, visuals, and more!

Let's Get Started:

Here are some helpful links to help get started and to navigate your Rethink Ed SEL program:

Logging In & Assigning Students:

- If you would like information about logging into the program [WATCH ME!](#)
 - ✓ Newton County Staff and Students will log into their Rethink Ed Accounts via Class Link
- If you need to assign students to yourself (if you do not see your students in "students" when you log in) [READ ME!](#)

Program Training:

- To learn more about the importance of Social Emotional Learning for adults and students: [WATCH ME!](#)
- To learn about the professional learning series for adults (SEL, Mental Health and Equity): [WATCH ME!](#)
- To learn about the student SEL curriculum and instructional content: [WATCH ME!](#)

Student Learning Center:

- To learn how to assign SEL videos and activities to your students learning center [WATCH ME! OR READ ME!](#)
- To learn how to view your students learning center [READ ME!](#)

Learning Management Systems:

- Using a Learning Management System to teach Rethink Ed SEL Content: [WATCHME!](#)

Getting Additional Help or Support:

- Email support@rethinked.com
- Click the "?" from your dashboard (after logging in) to access live chat support
- Sign up for a 1:1 virtual coaching session with the Rethink Ed Support Team: To register [CLICK HERE](#)

Other Helpful Resources:

- SEL Recommended Book List (ELA/Reading)-[README!](#)
- Rethink Ed Lessons & Objectives (locate every lesson by grade & objective to support your instruction)-[README!](#)
- Instructional Pacing Guide: [READ ME!](#)
- SEL Resources for Parents & Caregivers: [CLICK TO ACCESS!](#)

Supplemental Videos:

- Adults Coping with Trauma: [WATCH ME!](#)
- Social Injustice:
 - Early Elementary: Cultures Around The World: [WATCH ME!](#)
 - Secondary: Empathy and Social Change: [WATCH ME!](#)